

AIRPORT MASTER PLAN

INFORMATIONAL ONLY

PAGE 2 OF 3

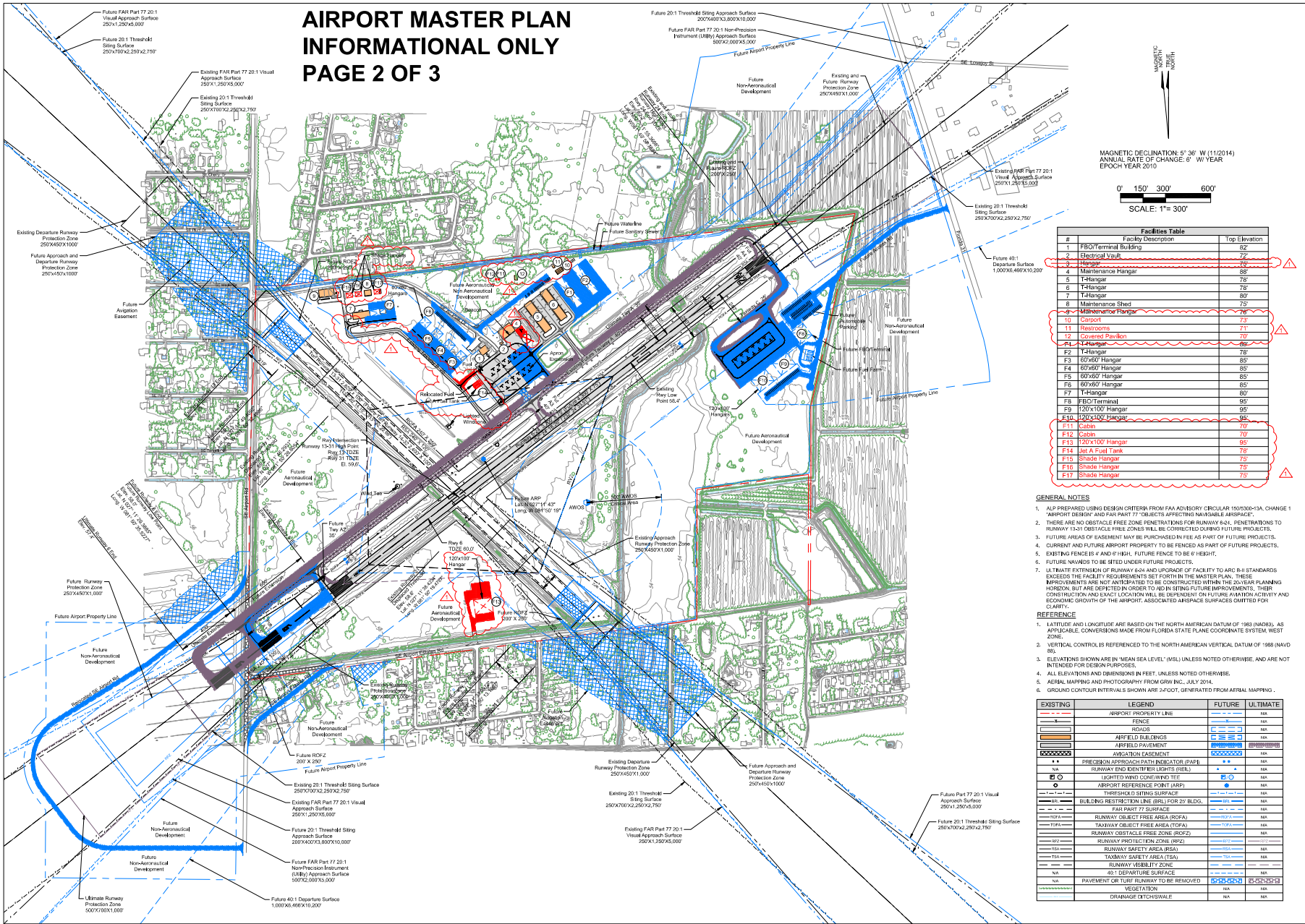

MAGNETIC DECLINATION: 8° 36' W (11/2014)
ANNUAL RATE OF CHANGE: 0' W/YEAR
EPOCH YEAR 2010

0' 150' 300' 600'
SCALE: 1" = 300'

#	Facility Description	Top Elevation
1	FBO/Terminal Building	82'
2	Electrical Vault	75'
3	Hangar	75'
4	Maintenance Hangar	88'
5	T-Hangar	78'
6	T-Hangar	78'
7	T-Hangar	80'
8	Maintenance Shed	75'
9	Maintenance Hangar	78'
10	Garport	73'
11	Restrooms	71'
12	Covered Stables	73'
F1	T-Hangar	88'
F2	T-Hangar	78'
F3	100'x60' Hangar	85'
F4	60'x60' Hangar	85'
F5	60'x60' Hangar	85'
F6	60'x60' Hangar	85'
F7	T-Hangar	85'
F8	FBO/Terminal	95'
F9	120'x100' Hangar	95'
F10	120'x100' Hangar	95'
F11	Cabin	70'
F12	Cabin	70'
F13	120'x100' Hangar	95'
F14	Light A Fuel Tank	75'
F15	Shade Hangar	75'
F16	Shade Hangar	75'
F17	Shade Hangar	75'

- GENERAL NOTES**
1. ALL PREPARED USING DESIGN CRITERIA FROM FAA ADVISORY CIRCULAR 150/5000-3A, CHANGE 1 AIRPORT DESIGN AND FAR PART 77 OBJECTS AFFECTING NAVIGABLE AIRSPACE.
 2. THERE ARE NO OBSTACLE FREE ZONE PENETRATIONS FOR RUNWAY 6A. PENETRATIONS TO RUNWAY 6A OBSTACLE FREE ZONE WILL BE CORRECTED DURING FUTURE PROJECTS.
 3. FUTURE AREAS OF EASEMENT MAY BE PURCHASED IN FEE AS PART OF FUTURE PROJECTS.
 4. CURRENT AND FUTURE AIRPORT PROPERTY TO BE FENCED AS PART OF FUTURE PROJECTS.
 5. EXISTING FENCES 4' AND 6' HIGH. FUTURE FENCE TO BE 6' HIGH.
 6. FUTURE NAVIGABLES TO BE SITED UNDER FUTURE PROJECTS.
 7. ULTIMATE EXPANSION OF RUNWAY 6A AND UPGRADE OF FACILITY TO AIC 8-I STANDARDS EXCEEDS THE FACILITY REQUIREMENTS SET FORTH IN THE MASTER PLAN. THESE IMPROVEMENTS ARE NOT ANTICIPATED TO BE CONSTRUCTED WITHIN THE 20-YEAR PLANNING HORIZON, BUT ARE DEPICTED IN ORDER TO HELP SETTING FUTURE IMPROVEMENTS. THEIR CONSTRUCTION AND EXACT LOCATION WILL BE DEPENDENT ON FUTURE AVIATION ACTIVITY AND ECONOMIC GROWTH OF THE AIRPORT. ASSOCIATED AIRSPACE SURFACES OMITTED FOR CLARITY.

- REFERENCE**
1. LATITUDE AND LONGITUDE ARE BASED ON THE NORTH AMERICAN DATUM OF 1983 (NAD83), AS APPLICABLE. CONVERSIONS MADE FROM FLORIDA STATE PLANE COORDINATE SYSTEM WEST ZONE.
 2. VERTICAL CONTROL IS REFERENCED TO THE NORTH AMERICAN VERTICAL DATUM OF 1988 (NAVD 88).
 3. ELEVATIONS SHOWN ARE IN MEAN SEA LEVEL (MSL) UNLESS NOTED OTHERWISE, AND ARE NOT INTENDED FOR DESIGN PURPOSES.
 4. ALL ELEVATIONS AND DIMENSIONS IN FEET, UNLESS NOTED OTHERWISE.
 5. AERIAL MAPPING AND PHOTOGRAPHY FROM GSI INC., JULY 2014.
 6. GROUND CONTOUR INTERVALS SHOWN ARE 2' FOOT, GENERATED FROM AERIAL MAPPING.

EXISTING	LEGEND	FUTURE	ULTIMATE
---	AIRPORT PROPERTY LINE	---	---
---	FENCE	---	---
---	ROADS	---	---
---	AIRFIELD BUILDINGS	---	---
---	AIRFIELD PAVEMENT	---	---
---	AVIATION EASEMENT	---	---
---	PRECISION APPROACH PATH INDICATOR (PAPI)	---	---
---	RUNWAY END IDENTIFIER LIGHTS (REIL)	---	---
---	LIGHTED WIND CONE/WIND TIE	---	---
---	AIRPORT REFERENCE POINT (ARP)	---	---
---	THRESHOLD SIBING SURFACE	---	---
---	BUILDING RESTRICTION LINE (BRL) FOR 20' BLDGS.	---	---
---	FAR PART 77 SURFACE	---	---
---	RUNWAY OBJECT FREE AREA (ROFA)	---	---
---	TAXIWAY OBJECT FREE AREA (TOFA)	---	---
---	RUNWAY OBSTACLE FREE ZONE (OFZ)	---	---
---	RUNWAY PROTECTION ZONE (RPZ)	---	---
---	RUNWAY SAFETY AREA (RSA)	---	---
---	TAXIWAY SAFETY AREA (TSA)	---	---
---	RUNWAY VISIBILITY ZONE	---	---
---	40' DEPARTURE SURFACE	---	---
---	PAVEMENT OR TURF RUNWAY TO BE REMOVED	---	---
---	VEGETATION	---	---
---	DRAINAGE DITCH/SWALE	---	---

HANSON
Engineering | Planning | Allied Services
Hanson Professional Services Inc.
3015 Town Center Pkwy, Suite 105
Lakewood Ranch, Florida 34202
Phone: (941) 342-8321
Fax: (941) 379-6474
EB-7981
Offices Nationwide
www.hanson-inc.com



AIRPORT LAYOUT PLAN

NO.	DATE	DESCRIPTION
1	JUNE 2024	UPDATING ALP WITH EXISTING PROPOSED STRUCTURES AND LAND IMPROVEMENTS/DECKMETRY

NO.	DATE	DESCRIPTION
15	DECEMBER 15, 2015	REV
16	NOVEMBER 15, 2014	REV

CAD FILE: 04-ALD-F.DWG

DESIGN BY: MLH 12/04/2014

DRAWN BY: MLH 12/04/2014

REVIEWED BY: MCM 08/13/2015

SHEET TITLE

FUTURE AIRPORT LAYOUT DRAWING

JUN 04, 2024 5:35 PM D:\0302649
11120851\240151\1\CD\AIRPORT\PROJECT\MAP\ALD-F.DWG

AIRPORT MASTER PLAN - PAGE 3 OF 3

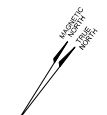
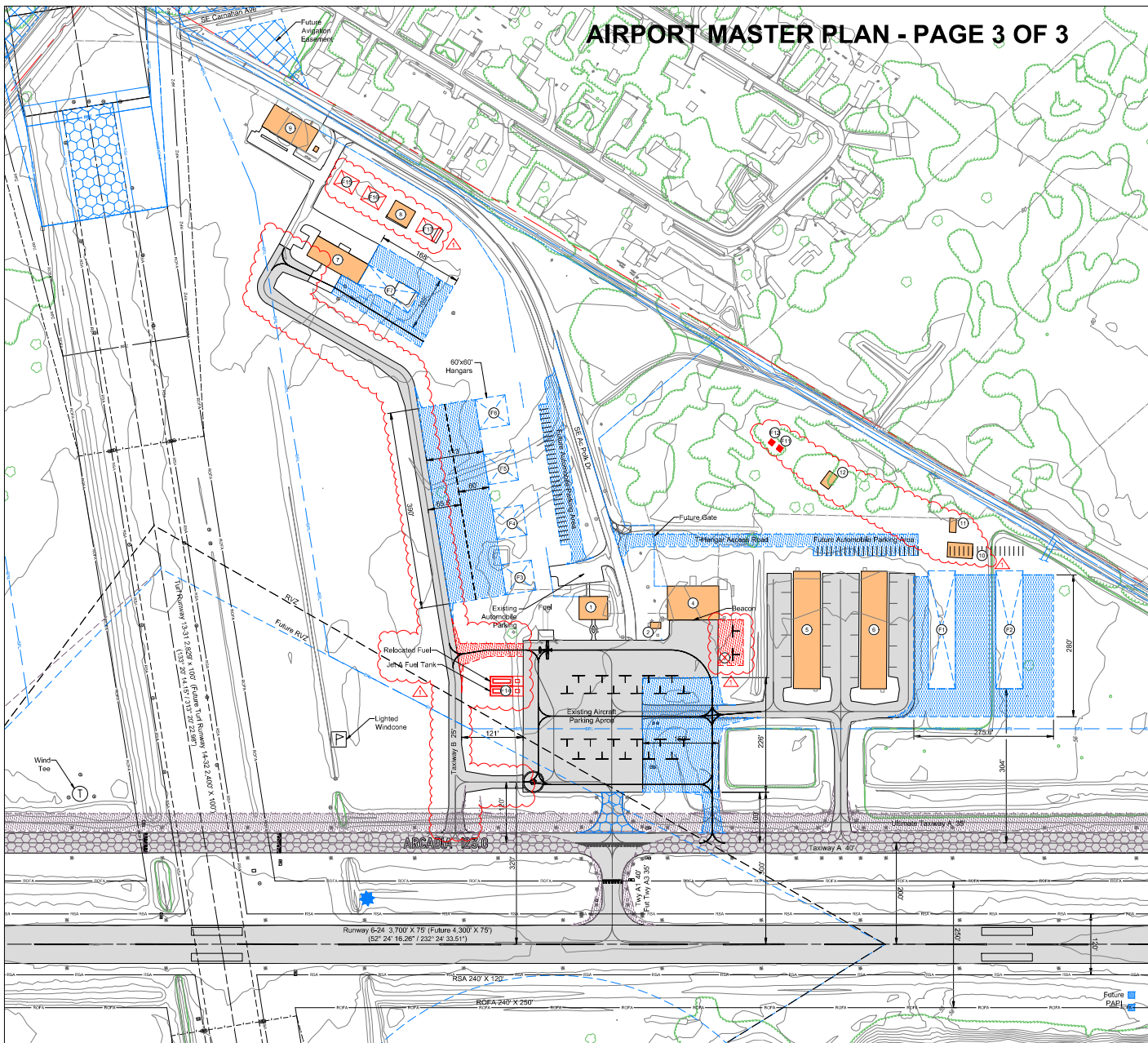

MAGNETIC DECLINATION: 8° 38' W (11/2014)
ANNUAL RATE OF CHANGE: 0' W/YEAR
EPOCH YEAR 2010

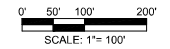

#	Facility Description	Top Elevation
1	FBO Terminal Building	52'
2	Electrical Vault	72'
3	Hangar	75'
4	Maintenance Hangar	68'
5	T-Hangar	78'
6	T-Hangar	78'
7	T-Hangar	80'
8	Maintenance Shed	75'
9	Maintenance Hangar	78'
10	Carport	73'
11	Restrooms	71'
12	Covered Pavillon	70'
F1	T-Hangar	78'
F2	T-Hangar	78'
F3	60'x60' Hangar	85'
F4	60'x60' Hangar	85'
F5	60'x60' Hangar	85'
F6	60'x60' Hangar	85'
F7	T-Hangar	90'
F11	Cabin	70'
F12	Cabin	70'
F13	120'x100' Hangar	95'
F14	Jet A Fuel Tank	78'
F15	Shade Hangar	75'
F16	Shade Hangar	75'
F17	Shade Hangar	75'

GENERAL NOTES

- ALL PREPARED USING DESIGN CRITERIA FROM FAA ADVISORY CIRCULAR 150/5000-13A, CHANGE 1 "AIRPORT DESIGN" AND PART 77 "OBJECTS AFFECTING NAVIGABLE AIRSPACE".
- THERE ARE NO OBSTACLE FREE ZONE PENETRATIONS FOR RUNWAY 6-24. PENETRATIONS TO RUNWAY 6-24 OBSTACLE FREE ZONE WILL BE CORRECTED DURING FUTURE PROJECTS.
- FUTURE AREAS OF EASEMENT MAY BE PURCHASED IN FEE AS PART OF FUTURE PROJECTS.
- CURRENT AND FUTURE AIRPORT PROPERTY TO BE FENCED AS PART OF FUTURE PROJECTS.
- EXISTING FENCE IS 4' AND 6' HIGH. FUTURE FENCE TO BE 6' HEIGHT.
- FUTURE NAVIGABLE TO BE SITED UNDER FUTURE PROJECTS.
- ULTIMATE EXTENSION OF RUNWAY 6-24 AND UPGRADE OF FACILITY TO ARC 5-B1 STANDARDS EXCEEDS THE FACILITY REQUIREMENTS SET FORTH IN THE MASTER PLAN. THESE IMPROVEMENTS ARE NOT ANTICIPATED TO BE CONSTRUCTED WITHIN THE 20-YEAR PLANNING HORIZON, BUT ARE DEPICTED IN ORDER TO BE IN SETTING FUTURE IMPROVEMENTS. THEIR CONSTRUCTION AND EXACT LOCATION WILL BE DEPENDENT ON FUTURE AVIATION ACTIVITY AND ECONOMIC GROWTH OF THE AIRPORT. ASSOCIATED AIRSPACE SURFACES OMITTED FOR CLARITY.

REFERENCE

- LATITUDE AND LONGITUDE ARE BASED ON THE NORTH AMERICAN DATUM OF 1983 (NAD83), AS APPLICABLE. CONVERSIONS MADE FROM FLORIDA STATE PLANE COORDINATE SYSTEM, WEST ZONE.
- VERTICAL CONTROL IS REFERENCED TO THE NORTH AMERICAN VERTICAL DATUM OF 1988 (NAVD 88).
- ELEVATIONS SHOWN ARE IN "MEAN SEA LEVEL" (MSL) UNLESS NOTED OTHERWISE, AND ARE NOT INTENDED FOR DESIGN PURPOSES.
- ALL ELEVATIONS AND DIMENSIONS IN FEET, UNLESS NOTED OTHERWISE.
- AERIAL MAPPING AND PHOTOGRAPHY FROM GRUY INC., JULY 2014.
- GROUND CONTOUR INTERVALS SHOWN ARE 2'-00". GENERATED FROM AERIAL MAPPING.

EXISTING	LEGEND	FUTURE	ULTIMATE
---	AIRPORT PROPERTY LINE	---	---
---	FENCE	---	---
---	ARFIELD BUILDINGS	---	---
---	ARFIELD PAVEMENT	---	---
---	PRECISION APPROACH PATH INDICATOR (PAPI)	---	---
---	RUNWAY END IDENTIFIER LIGHTS (REIL)	---	---
---	LIGHTED WIND CONE/WIND TOWER	---	---
---	AIRPORT REFERENCE POINT (ARP)	---	---
---	THRESHOLD SURFACE	---	---
---	BUILDING RESTRICTION LINE (BRL) FOR 2' BLDGS.	---	---
---	FAA PART 77 SURFACE	---	---
---	RUNWAY OBJECT FREE AREA (ROFA)	---	---
---	TAXIWAY OBJECT FREE AREA (TOFA)	---	---
---	RUNWAY OBSTACLE FREE ZONE (ROFZ)	---	---
---	RUNWAY PROTECTION ZONE (RPZ)	---	---
---	RUNWAY SAFETY AREA (RSA)	---	---
---	TAXIWAY SAFETY AREA (TSA)	---	---
---	RUNWAY USABILITY ZONE	---	---
---	40:1 DEPARTURE SURFACE	---	---
---	PAVEMENT OR TURF RUNWAY TO BE REMOVED	---	---
---	VEGETATION	---	---
---	DRAINAGE DITCH/SWALE	---	---



Hanson Professional Services Inc.
3015 Town Center Pkwy, Suite 105
Lakewood Ranch, Florida 34202
Phone: (941) 342-6321
Fax: (941) 379-6474
EB-7961
Offices Nationwide
www.hanson-inc.com



AIRPORT LAYOUT PLAN

NO.	DATE	DESCRIPTION
1	JUNE 2024	UPDATING ALP WITH EXISTING PROPOSED STRUCTURES AND LAND IMPROVEMENTS (DECKMATHY)

ISSUE: DECEMBER 15, 2015
PROJECT NO: 12001411
CAD FILE: 16-TERM.DWG
DESIGN BY: MLH 12/04/2014
DRAWN BY: MLH 12/04/2014
REVIEWED BY: MCM 08/13/2015

SHEET TITLE

TERMINAL AREA DRAWING - SHEET 1

JUN 04, 2024 5:42 PM D:\0202469\11\JOB\12001411\CD\AIRPORT\SHEET16-TERM.DWG